

ingenico

AXIUM EX6000

User Guide



www.ingenico.com

13-17 rue Pagès, 92150 Suresnes – France

Banks and Acquirers International Holding, SAS / 814 767 216 RCS Nanterre

Contents

Table of Contents	2
1. Introduction	3
2. Presentation	4
2.1 Content of the box	4
2.2 Overview of AXIUM EX6000	5
2.3 Key Locations and Functions	7
2.4 Touch Panel	7
3. Use of the terminal	8
3.1 Power on/Power off the terminal	8
3.2 Reading cards	9
3.3 Front scanner Usage	10
3.4 USB Type-C	11
4. Installation	11
4.1 Recommendations	11
4.2 Screen Protective film	12
4.3 Installing modules	12
4.4 Battery	14
4.5 Visual Impaired (VI) Accessory	15
5. Recommendations	16
5.1 Safety	16
5.2 Security of your terminal	18
5.3 Fixed installation	18
5.4 Cleaning the terminal	19
5.5 Transport and storage	20
6. Safety and Standards	21
7. Troubleshooting	26

1. Introduction

We hope that you will be fully satisfied with your new AXIUM EX6000 terminal.

Read this guide to understand and make the best use of your terminal. It presents you the necessary information about use, installation, maintenance, safety and security recommendations.



WARRANTY/SECURITY/GARANTIE/SÉCURITÉ

Use only the power supply included with the product to ensure best performance and safety. Maintenance should only be provided by Ingenico authorized technician.

Failure to comply with these instructions will void the manufacturer's responsibility.

Afin d'assurer les meilleures performances et votre sécurité, utiliser seulement le bloc d'alimentation livré par le fabricant avec le produit. La maintenance doit être réalisée seulement par un technicien agréé et autorisé par Ingenico.

Le non-respect de ces instructions dégage la responsabilité du fabricant.



This symbol indicates an important Warning.
Ce symbole indique un avertissement important.



This symbol indicates a piece of advice.

2. Presentation

2.1 Contents of the box

- **AXIUM EX6000 terminal**
- **Power adapter**
- **A battery pack**
- **This user guide**



WARNING/ATTENTION

The power supply unit provided with your equipment is specially designed for INGENICO AXIUM EX6000 terminal. Do not use any other power supply. The use of a power supply with apparently similar voltage/current characteristics may damage your terminal.

Le bloc d'alimentation fournit avec votre équipement est spécialement conçu pour les terminaux de paiement Ingenico. Ne pas utiliser d'autres sources d'alimentation. L'utilisation d'une alimentation électrique ayant des tensions et courant similaires peut endommager votre équipement.



ADVICE

Keep the package. It must be re-used whenever the terminal is shipped.

2.2 Overview of AXIUM EX6000

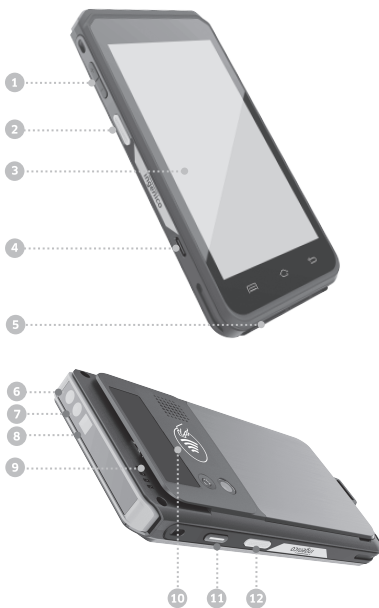

1) Volume Keys	2) Scan key
3) LCD and touch screen	4) USB Type-C connector
5) Smart card reader	6) Bar code scanner indicator LED
7) Bar code scanner	8) Bar code scanner illumination light
9) Magnetic card reader	10) Contactless landing zone
11) Power key	12) Scan key

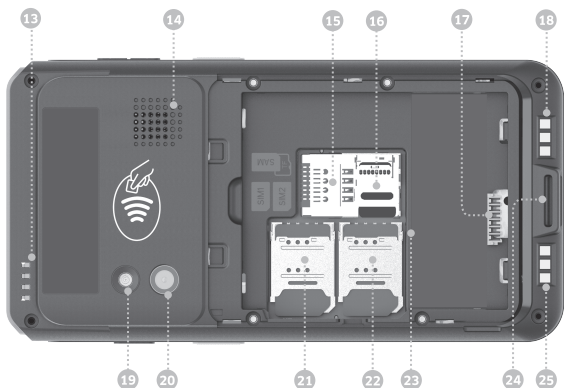

13) LEDs for Contactless Card	14) Speaker
15) SAM card slot	16) Micro SD slot
17) Battery socket	18) Base Charging interface -
19) Flash	20) Rear camera
21) SIM 1 card slot	22) SIM 2 card slot
23) Battery compartment	24) Lanyard hole
25) Base Charging interface +	

Weight

261g (including battery)

Dimension (L x W x H)

152.2 X 77.1 X 17.5mm / 5.9 x 3.0 x 0.69 in

Electrical mains network

100-240VAC/50-60Hz Class II

2.3 Key Locations and Functions

Three physical keys on the left side of the terminal: a scan key and two volume keys.

Two physical keys on the right side of the terminal: a power button and a scan key.

Three virtual keys at the bottom of the 5-inch screen: Menu, Home and Back keys.

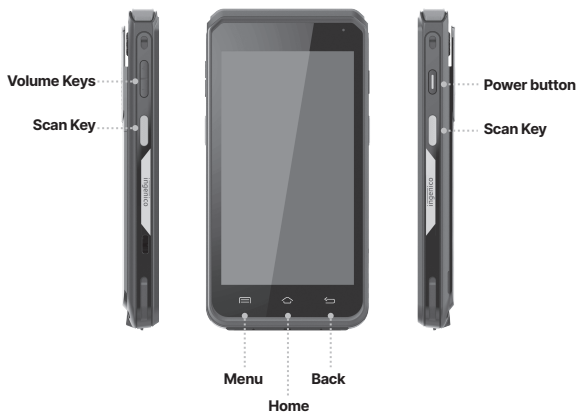

2.4 Touch Panel

The AXIUM EX6000 is equipped with touch panel that allows input via finger or with the use of a stylus.

3. Use of the terminal

3.1 Power on/Power off the terminal

Power On Terminal:

- Make sure the terminal battery is correctly installed.
- Press <Power> button for about 1s until the display is turned on.

Power Off Terminal:

- Press and hold <Power> button for more than 2s until the display shows the following menu.
- Press <Power off>.

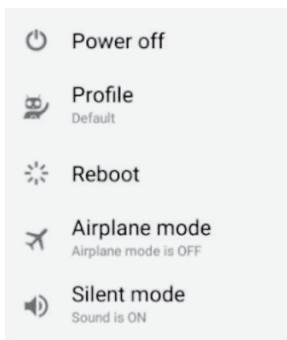

Battery Low:

- If the battery is empty, the terminal will automatically shut off.

Terminal restart:

- In the event of abnormal behavior of the terminal, press and hold the power button for 8 seconds to force the terminal to power off.

Screen saver mode:

- To conserve battery power, the screen may be turned off with a short press of the power button. (approximately 0.5 seconds)

3.2 Reading cards

Magnetic stripe card

- The card can be read bi-directionally, with the stripe facing the terminal.
- Use a consistent swipe motion to ensure a reliable card reading.

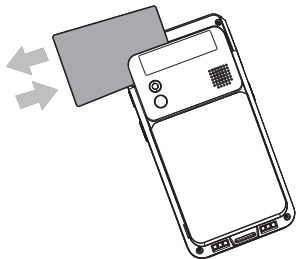

Contactless card

- Bring the card firmly up to the active zone.
- Keep the card close to the reader during the transaction.
- Do not remove the card until prompted by application or the LEDs indicate that the transaction has been completed.

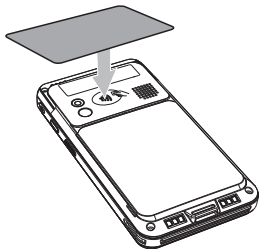

Smart card

- Insert the EMV card horizontally with the metal chip facing upward.
- Leave card in this position until the transaction is completed or prompted to remove it.

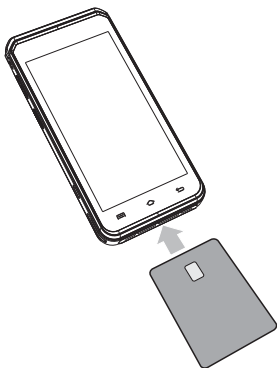

3.3 Front scanner Usage

- Press either scan button to start scanning.
- A red LED will be emitted from the window in front of the terminal.
- Align the red LED beam with the bar code to be scanned.
- A beep will sound when the barcode is successfully scanned.

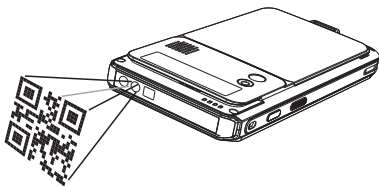

3.4 USB Type-C

- USB Type-C connector is located on the left side of the terminal.
- The connector manages Host and Slave connections.
- Connector is used for the audio Jack solution.

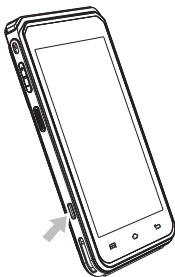

4. Installation

4.1 Recommendations

Operating conditions

Ambient temperature*	From -10°C to +50°C (14°F to 122°F)
Max relative humidity	From 10% to 90%, Non-condensing

(*Excluding battery charging)

Battery charging conditions

Ambient temperature	From 0°C to +40°C (32°F to 104°F)
---------------------	-----------------------------------

Storage conditions

Ambient temperature	From -20°C to +70°C (-4°F to 158°F)
Max relative humidity	From 5% to 90%, Non-condensing

4.2 Screen Protective film

Please remove the protective film from the display before usage.

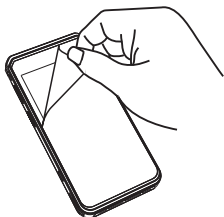

4.3 Installing modules

4.3.1 SAM/SIM1/SIM2



WARNING/ATTENTION

Switch off the terminal before opening the battery door.
Mettre hors tension le terminal avant d'ouvrir la trappe.



ADVICE

SIM and SAM cards share the same form factor, please ensure that the cards are inserted into the correct slot for the type of card.

The SAM/SIM connectors are located inside the terminal, in a closed compartment.

- Turn the terminal and remove the battery door.

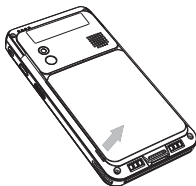

- SAM and SIM1,SIM2 are identified by the engraved marks on the lower housing.

- When introducing a SAM/SIM into its slot, be sure to put the cut corner as indicated on the picture.

- Close the battery door.

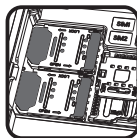
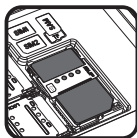
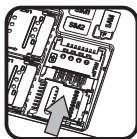

4.3.2 MicroSD Memory Card



WARNING/ATTENTION

Switch off the terminal before opening the battery door.
Mettre hors tension le terminal avant d'ouvrir la trappe.

MicroSD connector is located inside the terminal, in a closed compartment.

- Turn the terminal and remove the battery door.
- MicroSD are identified by the engraved marks on the lower housing.
- When introducing a MicroSD in its slot, be sure to put the cut corner as indicated on the picture.
- Close the battery door.

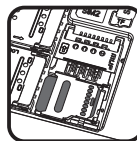
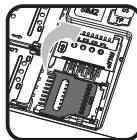

NOTE: The terminal supports SDHC MicroSD cards up to 32GB.

4.4 Battery

4.4.1 Charging the battery

- For safety reasons, the battery included with the terminal is not fully charged. Please charge the battery before use.
- When used daily, the terminal charges its battery each time the power adapter is connected. Charging starts automatically.
- In order to charge the battery:

Using the power adapter

- Connect the power adapter to the terminal USB type-C connector located on the left side of the terminal.
- Connect the power adapter to the power supply mains network.
- When charging, a red charge light at the top of the screen will display. This light will turn green when the terminal is fully charged" (check that behavior!).

4.4.2 Installing the battery



WARNING/ATTENTION

Check that the terminal is not connected to the main electric network.

Vérifier que le terminal n'est pas connecté au secteur.

- Power off terminal
- Turn the terminal over and remove the battery door
- Locate the battery pack connector beside the battery compartment
- Plug the battery pack connector according to the connector locating system.

- Place the battery pack in its compartment
- Replace the battery door

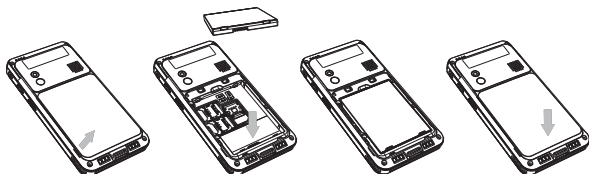

4.5 Visual Impaired (VI) Accessory

<p>Install</p> <ul style="list-style-type: none"> ● slide the accessory onto the terminal from the bottom. 	<p>Remove</p> <ul style="list-style-type: none"> ● slide the accessory down and away from the terminal

5. Recommendations

5.1 Safety

Lithium cell

The AXIUM EX6000 is fitted with an internal lithium cell which should only be accessed by a qualified technician.

Battery

- AXIUM EX6000 is fitted with battery specially designed for this terminal.
- Only use the approved power supplies, cables and batteries listed in the Ingenico's catalogue.
- Do not short-circuit the battery.
- Do not attempt to open the battery.
- Used batteries must be disposed of at the appropriated sites.

Battery lifespan depends on many factors including:

- Features used.
- Number of charge and discharge cycles.
- Use temperature.

Signs that the battery should be replaced:

- The battery fuel gauge / percentage meter drops randomly
- Charging finishes prematurely even though the battery did not accept much power
- Sudden capacity drops without warning
- Self-discharge rate soars and is often uneven
- The battery gets very hot during charging
- The battery starts bulging



CAUTION/ATTENTION

RISK OF EXPLOSION BATTERY IS REPLACED BY AN INCORRECT TYPE.
DISPOSE OF USED BATTERIES ACCORDING TO THE INSTRUCTIONS.
RISQUE D'EXPLOSION LA BATTERIE EST REMPLACÉE PAR UN TYPE
INCORRECT.
ÉLIMINEZ LES PILES UTILISÉES CONFORMÉMENT AUX INSTRUCTIONS.

SAM/SIM1/SIM2 Readers compartment

- The battery door for battery, SAM/SIM1/SIM2, readers located underneath the terminal, must be in place during the normal operation of the terminal.
- See sections “Installing modules” and “Installing the battery”.

On airplanes

- Your terminal must be switched off by removing the battery pack. Remove the battery from the terminal when on an airplane.
- Non-compliance with these safety rules may result in legal action and/or a ban on later access to cellular network services.

Explosion areas

- Some regulations restrict the use of radio equipment in chemical plants, fuel depots and any site where blasting is carried out.
- Operation near Fuel Pumps the terminal be protected by a specially fitted and certified cover enabling use in proximity to a fuel pump.

Thunderstorm weather

- According to some relevant reports, the mobile phone electromagnetic wave is good conductor of lightning.
- It is much easier to suffer lightning strike when the damp atmosphere form a magnetic conductivity, especially in open areas.
- Do not use wireless terminals under thunderstorm weather.

Electronic health appliances

- The terminal is a radio transmitter which may interfere with health appliances, such as hearing aids, pacemaker, hospital equipment, etc.
- Your doctor or the equipment manufacturer will be able to provide you with appropriate advice.

5.2 Security of your terminal

This device conforms to currently applicable PCI PTS security requirements.

Upon receipt of the terminal, it is recommended to check for signs of tampering or other unauthorized modifications to the terminal. It is recommended to check the following periodically:

- The keypad is firmly in place.
- There is no evidence of unusual wires that have been connected to any ports on your terminal or associated equipment.
- Device does not display any notifications of being in a “tampered state”.
 - In this state the terminal will repeatedly flash the message “Warning Detected” and further use of the terminal will not be possible.
 - If you observe the “Warning Detected” message, you should contact the terminal helpdesk immediately.

You are strongly advised to ensure that privileged access to your terminal is only granted to staff that have been independently verified as being trustworthy. The terminal must never be put in or left at a location where it could be stolen or replaced by another device.

5.3 Fixed installation

For situations where it is not possible for the user to pick up the device and shield their PIN entry, it should be installed in the following manner:

- Angled at 45 or more, so that oversight of the PIN entry from the rear of the device is not possible.
- Fitted in a swivel stand or fixed in the best possible position to prevent oversight of pin entry during use.
- There should be placement of conspicuous notices and educational material that informs the user to shield their PIN during PIN entry.

- The device must be installed so that oversight from other customers is prevented. This may be achieved through the placement of the lanes and device, so that the customer is automatically positioned between the device keypad and other customers. Alternatively, it may be achieved by the environment in which the device is installed, so that the checkout itself shields the PIN entry process.
- The terminal is recommended for indoor use only within the aforementioned environmental ranges in Section 4 of this document.

ADVICE

Positioning of the terminal on check stand must be in such a way to make cardholder PIN (Personal Identification Number) spying infeasible.



Installing device on an adjustable stand must be in such a way that consumers can swivel the terminal sideways and/or tilt it forwards/backwards to a position that makes visual observation of the PIN-entry process difficult.

Positioning of in-store security cameras such that the PIN- entry keypad is not visible.

NEVER ask the customer to divulge their PIN Code. Customers should be advised to ensure that they are not being overlooked when entering their PIN Code.

5.4 Cleaning the terminal

Good rules for proper cleaning of the terminal are:

- Unplug all wires from the terminal prior to cleaning.
- Apply soapy water or other approved cleaning product to a soft, non-abrasive cloth.

- CLEANING PRODUCT SHOULD BE APPLIED TO THE CLEANING CLOTH AND NOT DIRECTLY APPLIED OR SPRAYED TO THE TERMINAL. Failure to follow this step may result in damage to the terminal.
- Do not clean the electrical connections.
- Do not use solvents, detergents or abrasive products: Those materials might damage the plastic or electrical contacts.
- Avoid prolonged exposure of the terminal to the direct rays of the sun.
- Do not put anything other than credit cards into the slot of the smart card reader.

5.5 Transport and storage

When transporting the terminal

- Protect the terminal from snow, rain, and excessive exposure to the sun.
- Transport with care to avoid mechanical impact.
- Do not throw the unit forcibly. Prevent the package from intrusion during transportation to avoid breakage. The product should be stored in the original packaging.
- Do not store in warehouses that also contain harmful gases, or inflammable, explosive, or corrosive chemicals.
- Do not expose to strong mechanical vibrations or strong magnetic fields.
- Packaging should be stored at least 15 cm above the ground and be kept away from heat, cold, windows, or air inlet sources by at least 50cm.
- Follow the specific stored conditions as noted in Section 4 of this document.

6. Safety and Standards

FCC Warning

This device complies with part 15 of the FCC Rules. Operation is subject to the following two conditions: (1) This device may not cause harmful interference, and (2) this device must accept any interference received, including interference that may cause undesired operation.

Any Changes or modifications not expressly approved by the party responsible for compliance could void the user's authority to operate the equipment.

Note: This equipment has been tested and found to comply with the limits for a Class B digital device, pursuant to part 15 of the FCC Rules. These limits are designed to provide reasonable protection against harmful interference in a residential installation. This equipment generates, uses and can radiate radio frequency energy and, if not installed and used in accordance with the instructions, may cause harmful interference to radio communications. However, there is no guarantee that interference will not occur in a particular installation. If this equipment does cause harmful interference to radio or television reception, which can be determined by turning the equipment off and on, the user is encouraged to try to correct the interference by one or more of the following measures:

- Reorient or relocate the receiving antenna.
- Increase the separation between the equipment and receiver.
- Connect the equipment into an outlet on a circuit different from that to which the receiver is connected.
- Consult the dealer or an experienced radio/TV technician for help.

SAR tests are conducted using standard operating positions accepted by the FCC with the device transmitting at its highest certified power level in all tested frequency bands, although the SAR is determined at the highest certified power level, the actual SAR level of the device while operating can be well below the maximum value. Before a new device is available for sale to the public, it must be tested and certified to the FCC that it does not exceed the exposure limit established by the FCC. Tests for each device are performed in positions and locations as required by the FCC. For handheld worn operation, this device has been tested and meets the FCC RF exposure guidelines when used with an accessory designated for this product or when used with an accessory that contains no metal.

Non-compliance with the above restrictions may result in violation of RF exposure guidelines.

ISED C WARNING

This device complies with ISED license--exempt RSS standard (s). Operation is subject to the following two conditions: (1) this device may not cause interference, and (2) this device must accept any interference, including interference that may cause undesired operation of the device.

Le présent appareil est conforme aux CNR d'ISED applicables aux appareils radio exempts de licence.

L'exploitation est autorisée aux deux conditions suivantes:

- (1) l'appareil ne doit pas produire de brouillage, et
- (2) l'appareil doit accepter tout brouillage radioélectrique subi, même si le brouillage est susceptible d'en compromettre le fonctionnement.

Under Innovation, Science and Economic Development Canada regulations, this radio transmitter may only operate using an antenna of a type and maximum (or lesser) gain approved for the transmitter by Innovation, Science and Economic Development Canada. To reduce potential radio interference to other users, the antenna type and its gain should be so chosen that, the equivalent isotropically radiated power (e.i.r.p.) is not more than that necessary for successful communication.

Conformément à la réglementation ISED, le présent émetteur radio peut fonctionner avec une antenne d'un type et d'un gain maximal (ou inférieur) approuvé pour l'émetteur par Industry Canada. Dans le but de réduire les risques de brouillage radioélectrique à l'intention des autres utilisateurs, il faut choisir le type d'antenne et son gain de sorte que la puissance isotrope rayonnée équivalente (p.i.r.e.) ne dépasse pas l'intensité nécessaire à l'établissement d'une communication satisfaisante.

SAR tests are conducted using standard operating positions accepted by the ISED with the device transmitting at its highest certified power level in all tested frequency bands, although the SAR is determined at the highest certified power level, the actual SAR level of the device while operating can be well below the maximum value. Before a new device is available for sale to the public, it must be tested and certified to the ISED that it does not exceed the exposure limit established by the ISED, tests for each device are performed in positions and locations as required by the ISED. For handheld worn operation, this device has been tested and meets the ISED RF exposure guidelines when used with an accessory designated for this product or when used with an accessory that contains no metal.

Non-compliance with the above restrictions may result in violation of RF exposure guidelines.

5GHz Wifi should be used indoor only

Les tests SAR sont effectués à l'aide de positions d'exploitation standard acceptées par l'ISED avec la transmission de l'appareil à son niveau de puissance certifié le plus élevé dans toutes les bandes de fréquences testées, bien que le SAR soit déterminé au niveau de puissance certifié le plus élevé, le niveau SAR réel de l'appareil pendant l'exploitation peut être bien inférieur à la valeur maximale, avant qu'un nouvel appareil soit disponible à la vente au public. , il doit être testé et certifié à l'ISED qu'il ne dépasse pas la limite d'exposition établie par l'ISED, les tests pour chaque appareil sont effectués dans des positions et des emplacements comme l'exige l'ISED. Pour les opérations à main, cet appareil a été testé et répond aux lignes directrices d'exposition aux RF de la cited lorsqu'il est utilisé avec un accessoire désigné pour ce produit ou lorsqu'il est utilisé avec un accessoire qui ne contient pas de métal.

Le non-respect des restrictions ci-dessus peut entraîner une violation des lignes directrices sur l'exposition aux radiofréquences.

5 GHz band (W52,W53):Indoor use only

Bande de 5 GHz (W52,W53): utilisation à l'intérieur seulement

Environment (WEEE, Batteries and packaging)

This product is labeled in accordance with European Directives 2012/19/EU concerning Waste Electrical and Electronic Equipment (WEEE) and 2013/56/EU concerning Batteries and Accumulators. Those provisions are requiring producers and manufacturers to become liable for take-back, treatment and recycling upon end of life of equipment and batteries.

BATTERIES

If your product contains batteries, they must be disposed of at appropriate collection points.

THE PRODUCT



The crossed-out waste bin stuck on the product or its accessories means that the product belongs to the family of electrical and electronic equipment, and waste batteries must not be thrown away but collected separately and recycles.

Please contact your retailers for more detailed information about the compliance solution in place for disposing of your old product and used batteries.

Packaging waste must also be collected separately to assure a proper disposal and recycling.

In this way you can participate in the re-use and upgrading of Electrical and Electronic Equipment Waste, which can have an effect on the environment and human health.

Electrical power supply network

The electrical outlet must meet the following criteria:

- Use electrical outlets that are near the equipment and easily accessible.

The power supply label contains eighteen symbols:



CCC (China Compulsory Certificate) Mark



The Regulatory Compliance Mark (RCM)



International Efficiency Marking Protocol (Energy Star Level 6)



In door use only



“Conformite Europe enne” or CE Mark



Double insulation symbol



5 Years China RoHS symbol



10 Years China RoHS symbol



BSMI (Taiwan)



PSE Mark (Japan)



Recycle in accordance with the waste electronic & electrical equipment directive



Underwriters Laboratories Inc (US Compliance)



Made from recyclable material



Low density version of Polyethylene (LDPE)



Chlorinated Polyethylene (CPE)



Risk of explosion if the battery is incorrectly replaced or is placed in a fire



Dispose of batteries at a hazardous waste collection site or recycling facility



Direct Current

7. Troubleshooting

Q: The terminal cannot be started.

A: The device may be in a low energy status or an application running on the device may be in a defective state. Please ensure that the device is powered, and then reset the device. If this still fails, please contact our customer service department for help.

Q: Transaction Processing Failure

A: Following reasons are likely to cause transaction failure: damaged magnetic card or smart card SAM card, damaged card reader, improper operation of card swiping, damaged or unconnected, unconnected phone line, etc.

- Try to use more than one magnetic card to test the transaction, to confirm the failure is not caused by magnetic card.
- Make sure card swiping is operated correctly.
- Manually process the transaction instead of card reader. If manual transaction works, the failure may be caused by magnetic card reader.
- Use more than one smart card to test the transaction, to confirm the failure is not caused by smart card. Make sure the SAM card is correctly inserted into the card slot.
- Check if the SIM card is installed correctly and local wireless communication network functions or not.

If there is still problem, please contact our customer service center.

"INGENICO is a trademark of BANKS AND ACQUIRERS INTERNATIONAL HOLDING . This Document is Copyright © 2023 BANKS AND ACQUIRERS INTERNATIONAL HOLDING . BANKS AND ACQUIRERS INTERNATIONAL HOLDING retains full copyright ownership, rights and protection in all material contained in this document. The recipient can receive this document on the condition that he will keep the document confidential and will not use its contents in any form or by any means, except as agreed beforehand, without the prior written permission of BANKS AND ACQUIRERS INTERNATIONAL HOLDING. Moreover, nobody is authorized to place this document at the disposal of any third party without the prior written permission of BANKS AND ACQUIRERS INTERNATIONAL HOLDING. If such permission is granted, it will be subject to the condition that the recipient ensures that any other recipient of this document, or information contained therein, is held responsible to BANKS AND ACQUIRERS INTERNATIONAL HOLDING for the confidentiality of that information. Care has been taken to ensure that the content of this document is as accurate as possible. BANKS AND ACQUIRERS INTERNATIONAL HOLDING however declines any responsibility for inaccurate, incomplete or outdated information. The contents of this document may change from time to time without prior notice, and do not create, specify, modify or replace any new or prior contractual obligations agreed upon in writing between BANKS AND ACQUIRERS INTERNATIONAL HOLDING and the user. BANKS AND ACQUIRERS INTERNATIONAL HOLDING is not responsible for any use of this device, which would be non-consistent with the present document. All trademarks used in this document remain the property of their rightful owners"

www.ingenico.com

13-17 rue Pagès, 92150 Suresnes – France

Banks and Acquirers International Holding, SAS / 814 767 216 RCS Nanterre

